

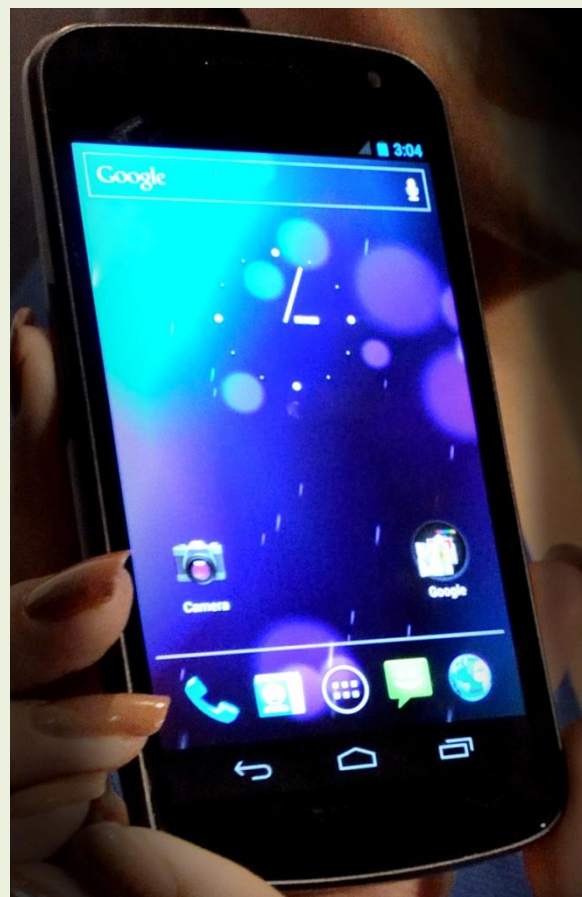

Mobile Phone Camera Hints





The “cog wheel” is the way into some interesting camera settings.

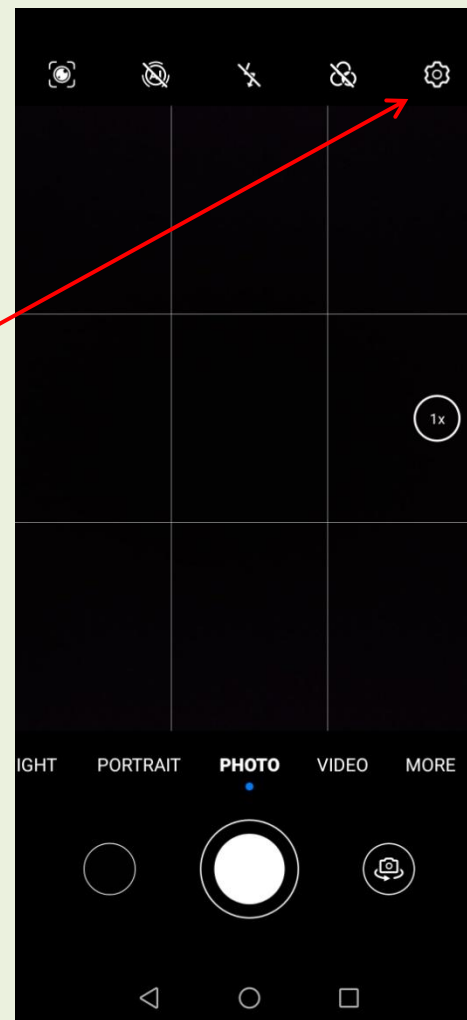



Internal phone memory can be limited so save your photos on the memory card if one is installed.

The timer is useful for including yourself in the picture or to avoid camera shake if you are taking night shots.

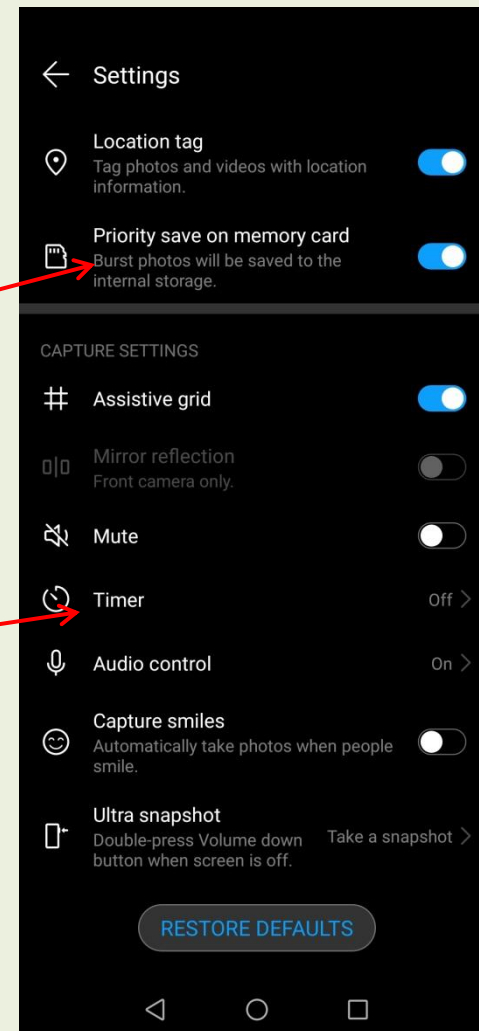



The assistive grid helps with framing your photographs.

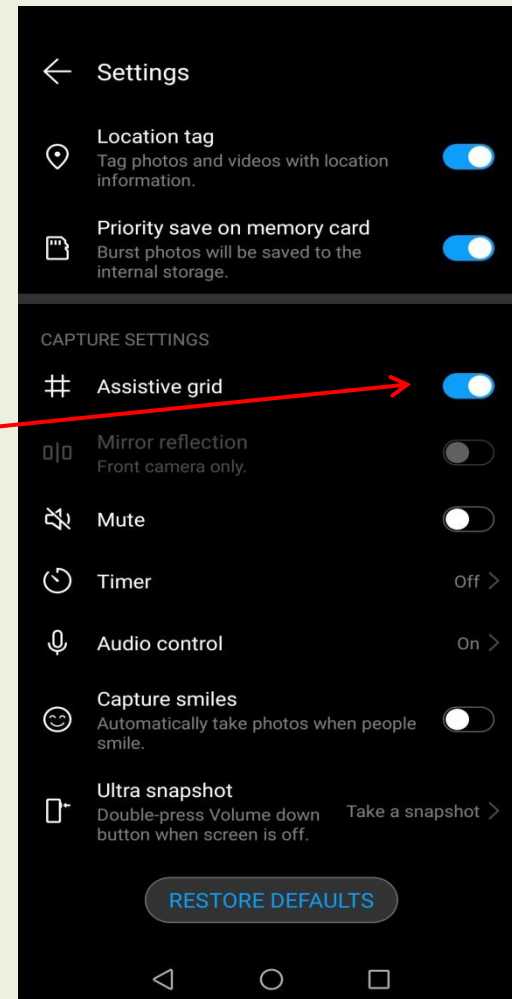



The grid can help create a more visually pleasing photograph by placing the subject using the *rule of thirds*.





Use Audio Control to change the way you take the picture. Audio control can eliminate camera shake as you don't have to touch the shutter button.

Saying "cheese" usually results in everyone smiling but you do get funny looks if you're photographing a flower!

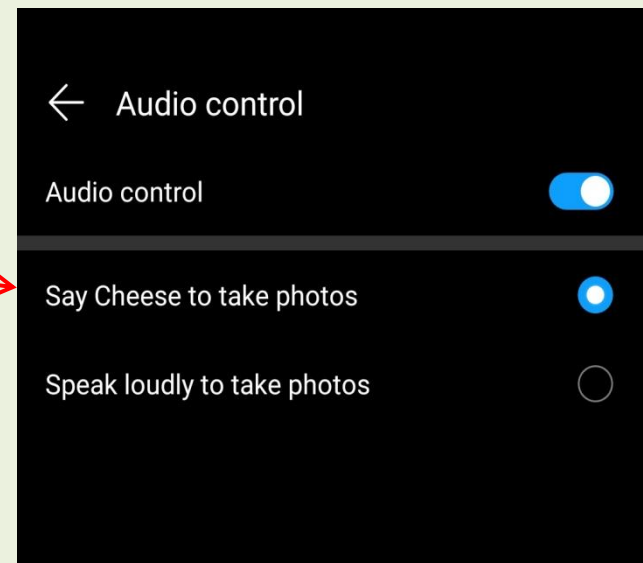
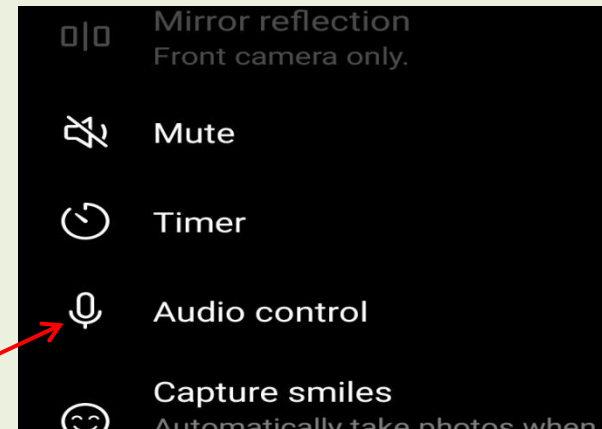



Back to the main screen, click on *Aperture* and this symbol may pop up.

Clicking on the symbol makes it possible to change the aperture or in other words, the light getting into the camera. The lower the number, the more light and also focus is more critical and the picture background is more likely to be out of focus. The higher the number, the converse is true.

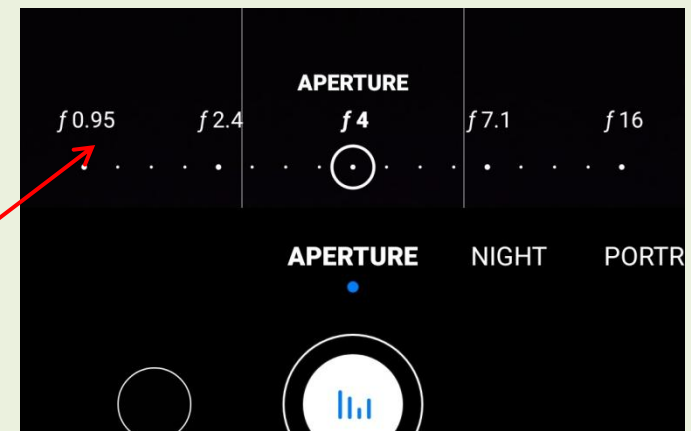
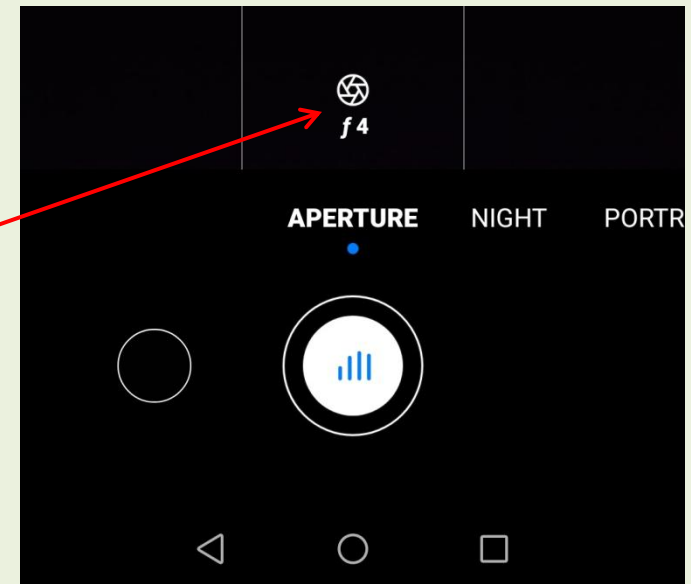



If you have a *Night* button then you may be able to alter the *ISO* number or the light sensitivity of the camera. The lower the number then more light is needed. For low light levels set the *ISO* number higher but your pictures may appear more “grainy”.

Pressing the *More* button will give you a whole lot of other options which are worth investigating. Some of course are a bit frivolous but others can be useful.

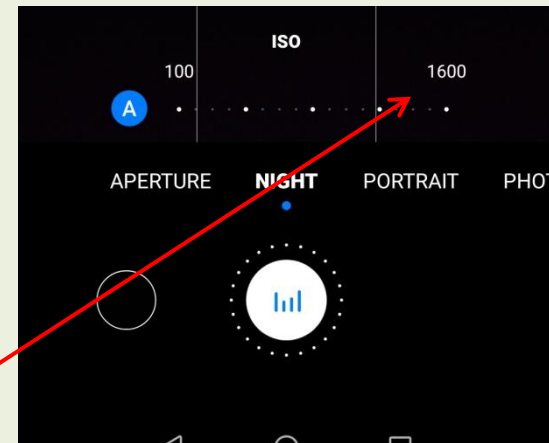



In some modes you may see a **1x** symbol in a circle. This denotes the state of *ZOOM* of the lens.

To zoom in and out “pinch” the screen with two fingers or alternatively tap the circle then use the slider which appears.

Remember, the greater the zoom enlargement, the more camera shake is amplified so support the camera.

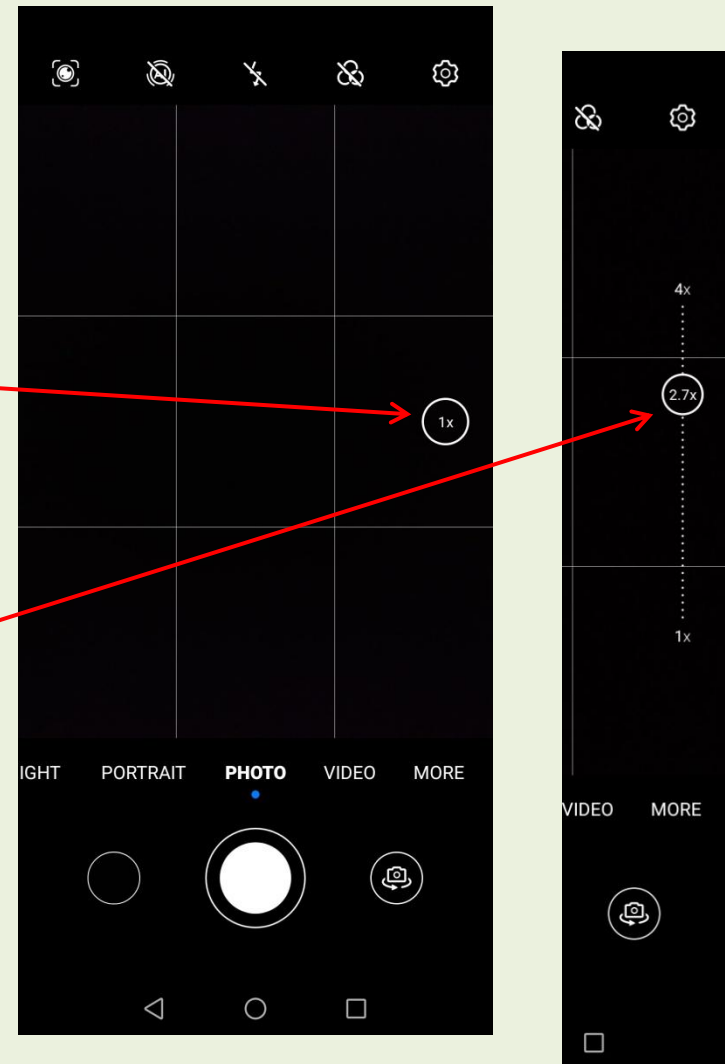



Flash photography is a subject on its own. However, flash is available on phone cameras but should be used sparingly. Flash does tend to drain the battery when used. Phone cameras are set up to use available light so the flash facility should generally be switched off or at least set to automatic.





Modern phone cameras are surprisingly good and can produce great pictures.

Investigate all the features included with your camera but most of all, **have fun using it.**

